

CONDITIONS OF APPROVAL:

Open Issues: 14 These issues are currently being filtered

Engineering - Site Plan Checklist

General Issues

1. V. Site Permits

amanda.ray@franklin.tn.gov The Applications have been uploaded. These shall be completed and submitted along with the fees to Engineering.

2. I. Grading Plan

lance.fittro@franklin.tn.gov Due to the shallow bedrock encountered relative to the proposed depths of the stormwater BMPs, applicant shall add the following note to the Grading and Drainage Plan as well as the BMP details:

"Where bedrock is encountered during excavation of the BMP, an additional 2 feet of bedrock shall be removed below the bottom sump elevation of the BMP and backfilled with clean #57 stone."

Fire-Planning

[Temple Fitness 6-27-16.pdf](#)

3. Fire Protection

geoffw@franklin.tn.gov The flow test information is dated 8/10/2016 and is outside the 6-month time frame allowed for flow tests. The applicant has been advised of this requirement since the initial review June 2016.

Flow test dated 8/10/2016 has a submission date of 4/7/2017 and is not within the acceptable 6-month time frame.

The applicant shall provide the results of a full demand fire flow test performed within 6 months of the subsequent submittal date (not the original project submittal date).
[Edited By Geoff Woolard]

Performance Agreement and Surety

General Issues

4. Engineering Sureties

kevin.long@franklintn.gov

Applicant shall post sureties in the following amounts:

I. City Water:	
II. City Sewer:	
III. City Streets:	
IV. Private Streets:	\$ 33,000
V. Traffic Signals:	
VI. Public Sidewalks:	\$ 8,000
VII. Stormwater Drainage:	\$ 5,000
VIII. Green Infrastructure:	\$ 16,000
IX. ITS Elements:	

Sureties are calculated, posted to, and approved during the Site Plan approval process. Sureties shall be posted prior to obtaining a building permit. Where a building permit is not expected, sureties shall be posted prior to obtaining a grading permit. If a Final Plat is approved at any time during the development process, all sureties will be transferred to said plat as a Condition of Approval.

Any driveway or related encroachment on City of Franklin right-of-way, including the modification, revision, or change in use of any existing driveway facilities, shall require a Street Access surety to be posted with the City of Franklin.

5. Landscape

larry.mizell@franklintn.gov Landscape surety \$15,000.00

Stormwater

General Issues

6. Limits of Disturbance

ellen.moore@franklintn.gov LOD shall include any regrading to be completed to achieve positive flow at the outfall for both sites. This area shall also be included in any stabilization shown on the final EPSC plan.

7. Bioretention

ellen.moore@franklintn.gov Applicant shall revise the following:

- Add a note stating, "All underdrains within the bioretention area shall be within the stone layer. Underdrains cannot be installed within the soil layer."
- Add a note stating, "If bedrock is encountered during excavation of the bioretention area, an additional 2' shall be excavated and back filled with #57 stone."

8. EPSC

ellen.moore@franklintn.gov Previous comment not fully addressed. Applicant shall provide outfall protection for the underdrain outfall into the dry detention basin.

9. Bioretention

ellen.moore@franklintn.gov A 1' tall berm made of non-erodible material (i.e. a concrete curb) shall be shown in between the pre-treatment cell and the dry detention pond to prevent short circuiting of stormwater. The water draining to the curb cut beside the dumpster pad is not being treated by the pre-treatment forebay. All stormwater being treated by the bioretention area shall be routed to a pre-treatment forebay before entering the bioretention area.

Applicant shall also show a detail for the gravel diaphragms to be utilized.

[Edited By Ellen Moore]

10. Long Term Maintenance Plan

jeff.willoughby@franklintn.gov Include L2.0

Water/Sewer

6192 Civil Set.pdf

11. Water utiltiy sizes

ben.mcneil@franklintn.gov Applicant shall note the proposed water utility sizes on the utility plan.

Temple Fitness 6-27-16.pdf

12. Domestic water

ben.mcneil@franklintn.gov Applicant has shown the fire hydrant as private, but a note shall be added for the hydrant to be painted silver to indicate private.

Zoning

General Issues

13. Lighting

shanna.mccoy@franklintn.gov The photometric sheet included does not match the site layout

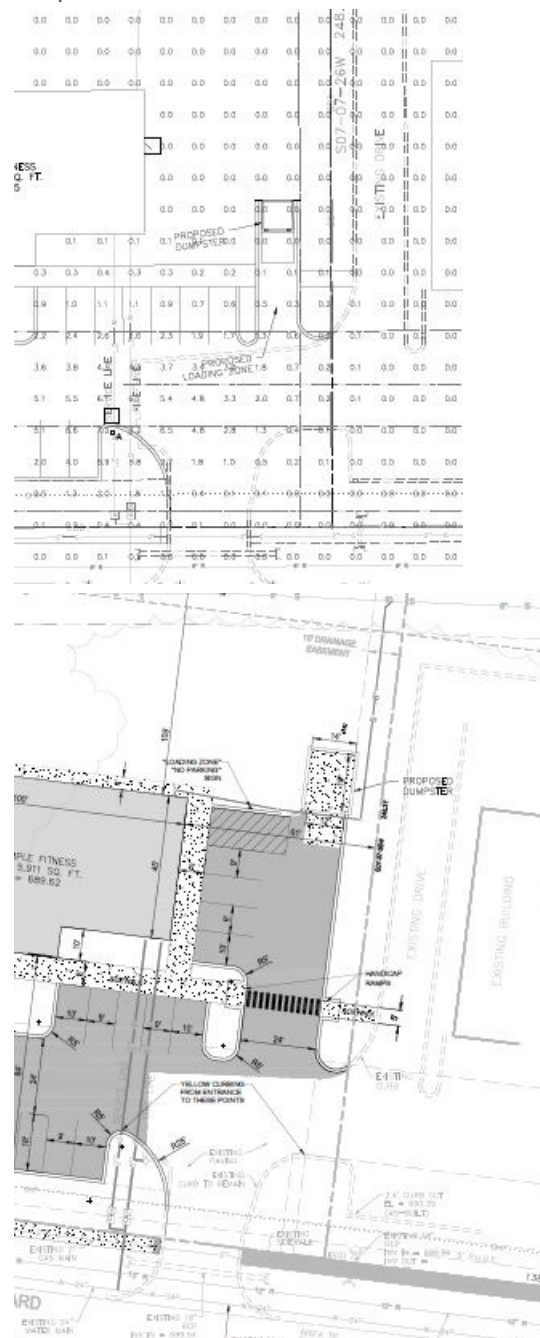

14. Dumpsters

shanna.mccoy@franklintn.gov A pedestrian door is required on the dumpster enclosure.