

GRAPHIC SCALE

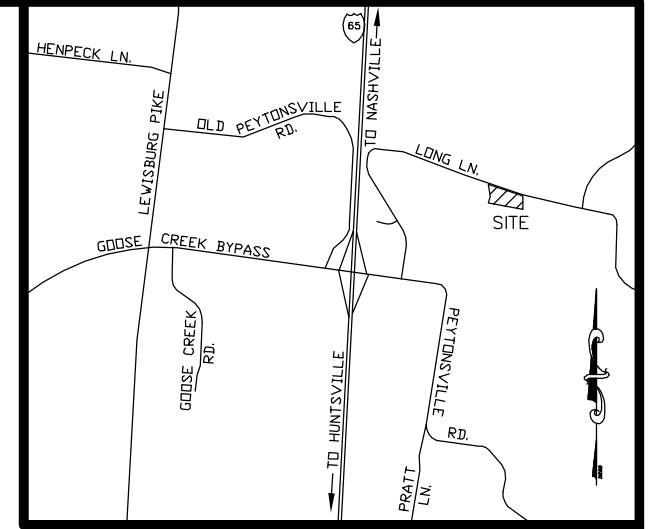

SURVEYOR'S CERTIFICATE:

I (WE) HEREBY CERTIFY THAT THIS IS A CATEGORY I SURVEY AND THE RATIO OF PRECISION OF THE UNADJUSTED SURVEY IS GREATER THAN 1: 10,000 AS SHOWN HEREON.

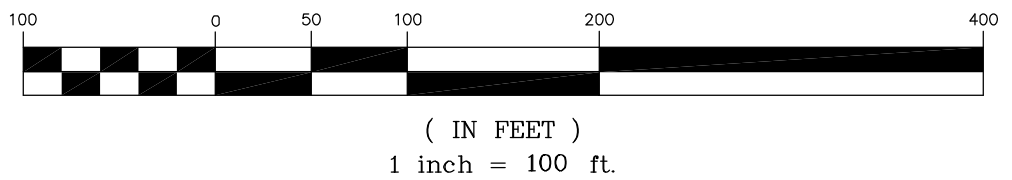
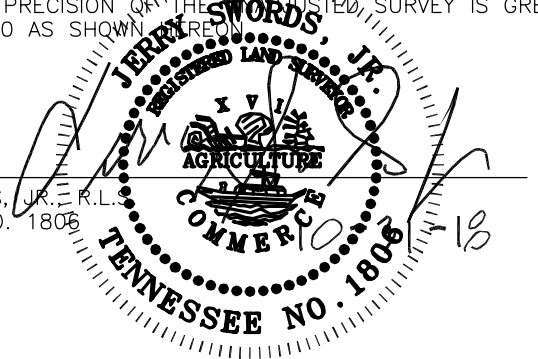

JERRY SWORDS, JR., R.L.
TENN. REG. NO. 1806

NOTES:

1. THIS SURVEY MEETS THE REQUIREMENTS OF AN URBAN LAND SURVEY (CATEGORY 1), WITH A RATIO OF PRECISION OF THE UNADJUSTED SURVEY GREATER THAN 1:10,000 AS PER STANDARDS OF PRACTICE ADOPTED BY THE BOARD OF EXAMINERS FOR LAND SURVEYORS, STATE OF TENNESSEE.
2. BEARING SHOWN BASED ON TENNESSEE STATE PLANE COORDINATE SYSTEM 1983.
3. PROPERTY IS ZONED MGA-1.
4. THIS PROPERTY IS NOT LOCATED IN A FLOOD HAZARD AREA ACCORDING TO FEDERAL EMERGENCY MANAGEMENT AGENCY FLOOD INSURANCE RATE MAP, PANEL NO. 47187C0355F, DATED SEPTEMBER 29, 2006.
5. UNDERGROUND UTILITY LOCATIONS SHOWN HEREON WERE TAKEN FROM FIELD LOCATIONS OF VISIBLE ABOVEGROUND STRUCTURES (AND PERTINENT UTILITY MAPS) AND ARE APPROXIMATE ONLY. UTILITIES SHOULD BE FIELD VERIFIED BY THE PROPER UTILITY AUTHORITY HAVING JURISDICTION PRIOR TO ANY DIGGING.
6. TOPOGRAPHIC INFORMATION BASED ON FIELD RUN RANDOM SHOTS AND HAVE BEEN ADJUSTED FOR TEMPERATURE. ELEVATIONS ARE BASED ON NAVD '88.
7. NO TITLE REPORT WAS FURNISHED TO THIS SURVEYOR AT THE TIME OF THE SURVEY.

Legend

- EIP Existing Iron Pipe
- T PST Metal Fence Post
- Utility Pole/Guy
- OE— Overhead Utility
- x— Fence Line
- Sign
- ⊗ Fire Hydrant
- ⊠ Water Valve
- ⊙ Sanitary Sewer Manhole
- SS— 8" Sanitary Sewer Line
- G— Gas Line
- ST— Storm Sewer Line
- WM— Waterline
- ⊕ Water Meter

TOTAL AREA = 304,904 SQUARE FEET OR 7.00 ACRES±

DEED REFERENCE:

BEING PROPERTY CONVEYED TO MICHAEL E. & DENISE E. BENNETT BY DEED BOOK 7088, PAGE 793, R.O.W.C.

PROPERTY MAP REFERENCE:

BEING PARCEL NO. 179.04 AS SHOWN ON WILLIAMSON COUNTY PROPERTY MAP NO. 106.

AS BUILT SURVEY
LONG LANE
Map 106, Parcel 179.04
TENTH CIVIL DISTRICT—WILLIAMSON COUNTY—TENNESSEE

S & A Surveying, Inc.

306 Bluegrass Circle
Lebanon, Tennessee 37090

PHONE (615) 394-7564
sasurvey98@gmail.com

PROJ.: 18-036 DATE: 10/20/2018 SHEET 1 OF 1