

HIGHLANDS AT LADD PARK, SECTION 18, FINAL PLAT
 FRANKLIN MUNICIPAL PLANNING COMMISSION
 03/24/2016

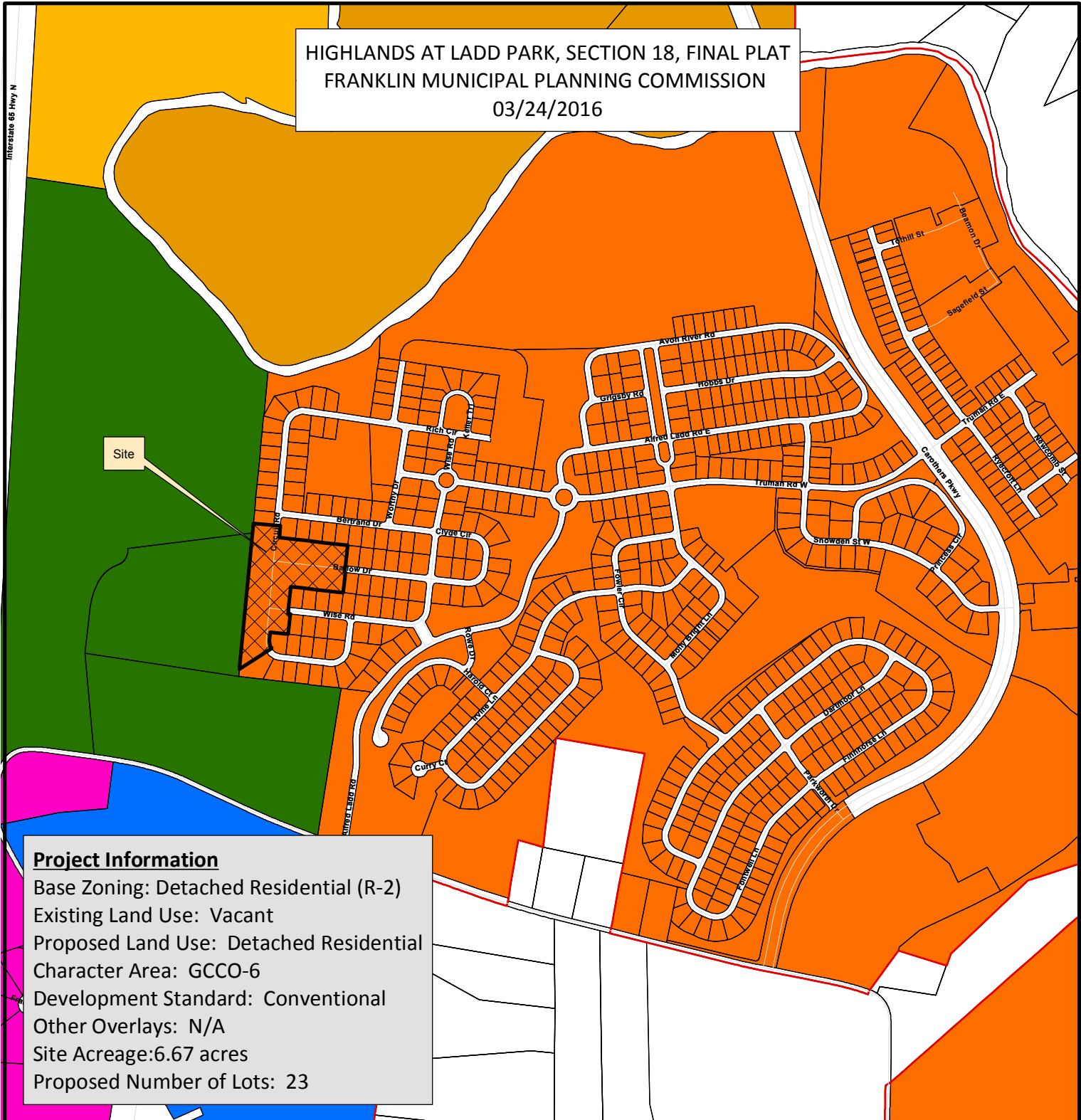

Project Information
 Base Zoning: Detached Residential (R-2)
 Existing Land Use: Vacant
 Proposed Land Use: Detached Residential
 Character Area: GCCO-6
 Development Standard: Conventional
 Other Overlays: N/A
 Site Acreage: 6.67 acres
 Proposed Number of Lots: 23

- | | | | |
|--|--|--|-------------------------------------|
| | Highlands at Ladd Park Sec 18 | | SD-X Specific Development-Variety |
| | AG Agricultural District | | OR Office Residential District |
| | ER Estate Residential | | GO General Office District |
| | R-1 Residential District | | CC Central Commercial District |
| | R-2 Residential District | | NC Neighborhood Commercial District |
| | R-3 Residential District | | GC General Commercial District |
| | R-6 Historic Core Residential District | | LI Light Industrial District |
| | RM-10 Attached 10 Residential District | | HI Heavy Industrial District |
| | RM-15 Attached 15 Residential District | | CI Civic and Institutional District |
| | RM-20 Attached 20 Residential District | | |
| | SD-R Specific Development-Residential | | |

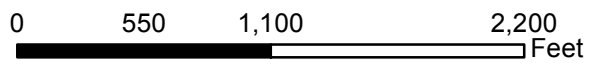

This map was created by the Franklin Planning Department. It was compiled from the most authentic information available. The City is not responsible for any errors or omissions contained herein. All data and materials (c) copyright 2016. All rights reserved.