

MH - Concept 3.0.dwg

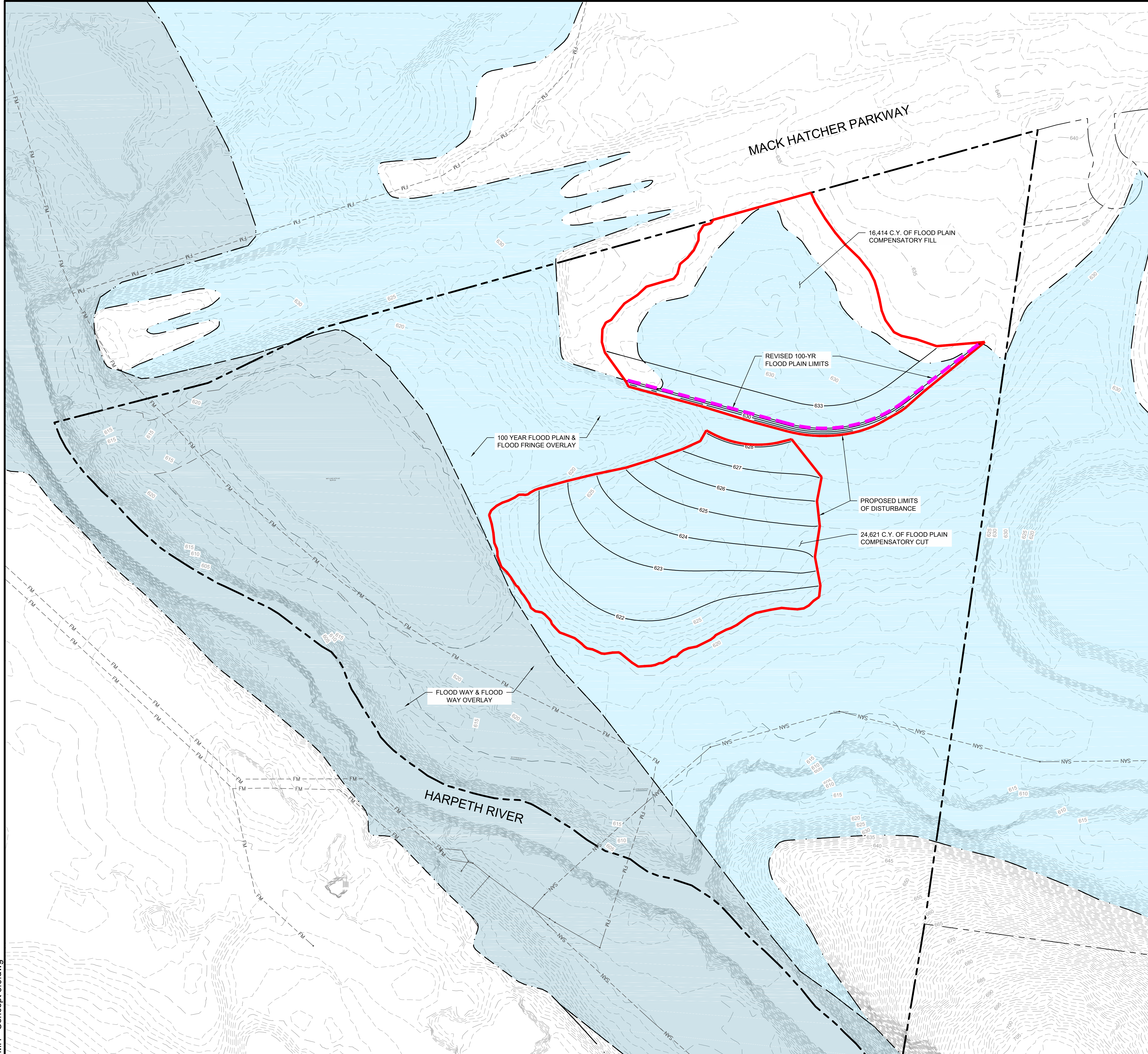

VICINITY MAP
NOT TO SCALE

FULMER
ENGINEERING

2002 RICHARD JONES RD - SUITE C304
NASHVILLE, TENNESSEE 37215
INFO@FULMERENG.COM - (615) 516-8477

PROPOSED FLOOD PLAIN CUT FILL EXHIBIT

CONCEPTUAL PLANS FOR:
CITY OF FRANKLIN
MACK HATCHER PARKWAY
FRANKLIN, WILLIAMSON COUNTY, TENNESSEE 37065

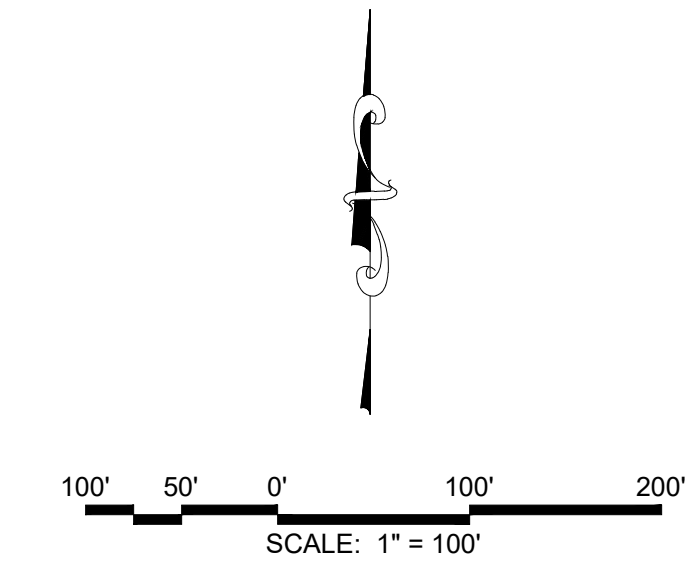

HISTORIC
FRANKLIN
TENNESSEE

DR.	DATE	DESCRIPTION

C3.0

MACK HATCHER