

HIGHLANDS AT LADD PARK PUD SUBDIVISION,
 FINAL PLAT, SECTION 37
 FRANKLIN MUNICIPAL PLANNING COMMISSION
 12/14/17

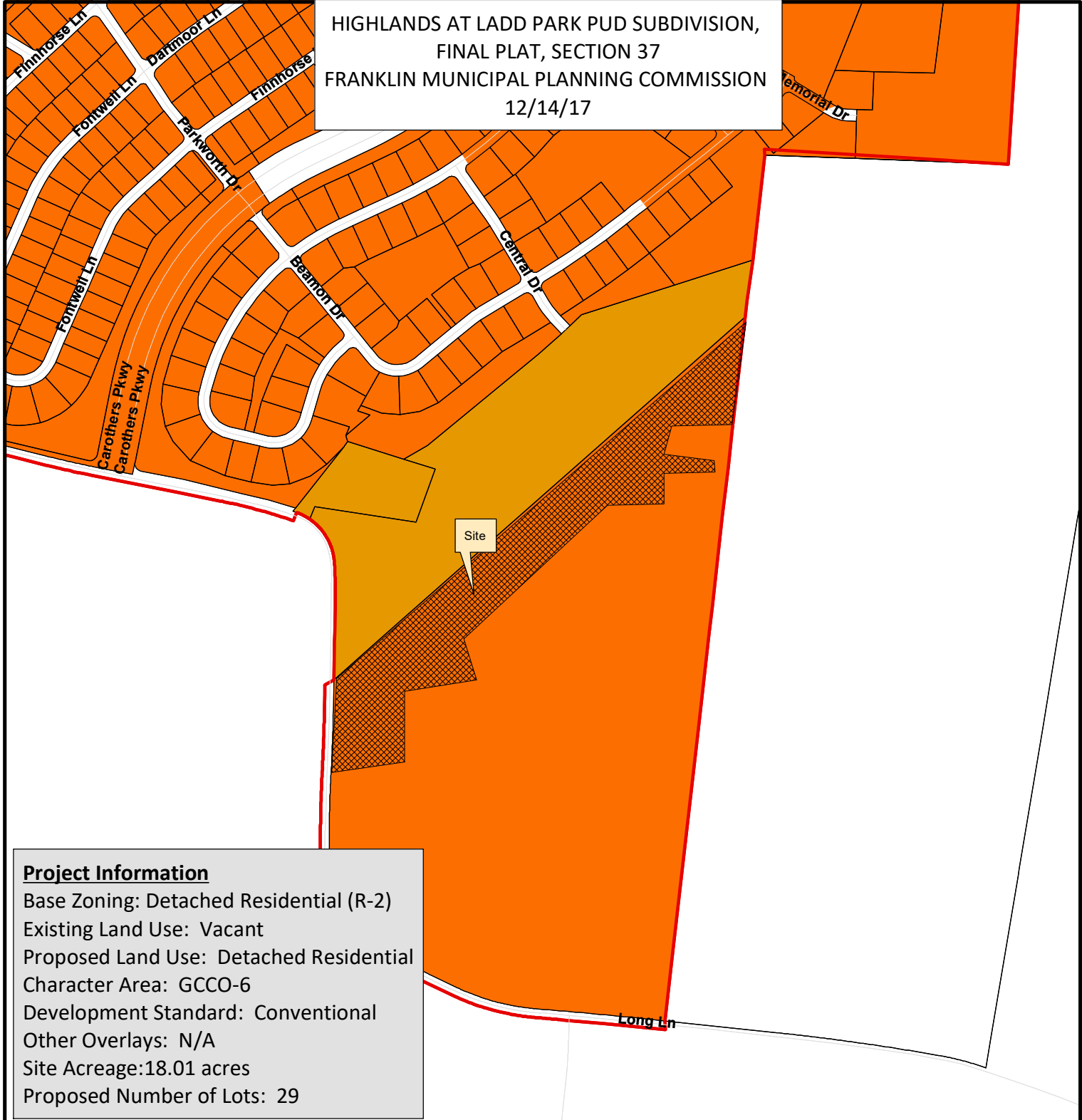

Project Information
 Base Zoning: Detached Residential (R-2)
 Existing Land Use: Vacant
 Proposed Land Use: Detached Residential
 Character Area: GCCO-6
 Development Standard: Conventional
 Other Overlays: N/A
 Site Acreage: 18.01 acres
 Proposed Number of Lots: 29

- | | |
|--|-------------------------------------|
| AG Agricultural District | OR Office Residential District |
| ER Estate Residential | GO General Office District |
| R-1 Residential District | CC Central Commercial District |
| R-2 Residential District | NC Neighborhood Commercial District |
| R-3 Residential District | GC General Commercial District |
| R-6 Residential District | LI Light Industrial District |
| RM-10 Attached 10 Residential District | HI Heavy Industrial District |
| RM-15 Attached 15 Residential District | CI Civic and Institutional District |
| RM-20 Attached 20 Residential District | |
| SD-R Specific Development-Residential | |
| SD-X Specific Development-Variety | |

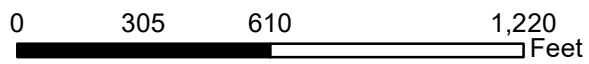

This map was created by the Franklin Planning Department. It was compiled from the most authentic information available. The City is not responsible for any errors or omissions contained hereon. All data and materials (c) copyright 2016. All rights reserved.