

WESTHAVEN PUD SUBDIVISION, FINAL PLAT, SECTION 47
 FRANKLIN MUNICIPAL PLANNING COMMISSION
 11/11/2017

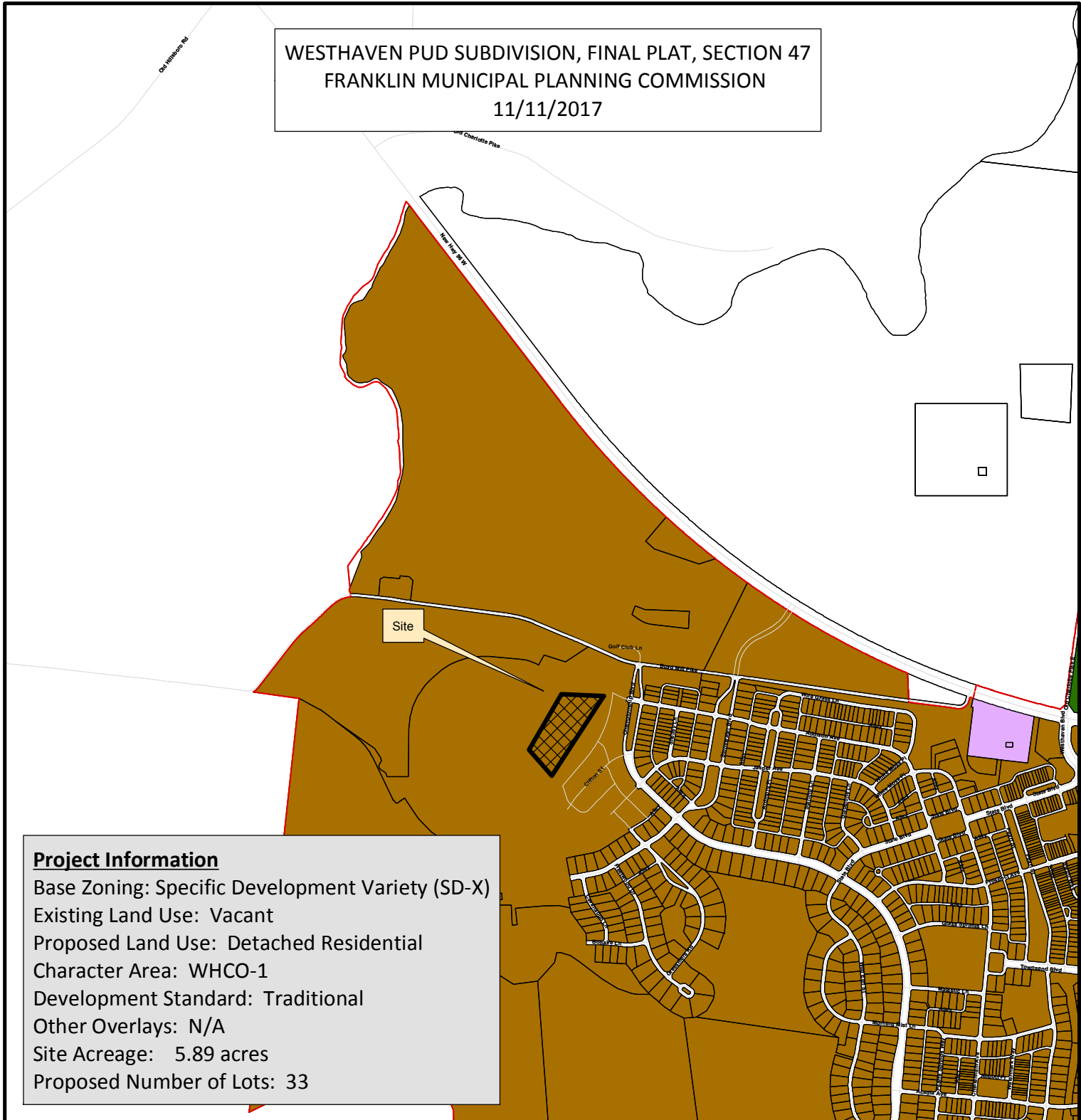

Project Information
 Base Zoning: Specific Development Variety (SD-X)
 Existing Land Use: Vacant
 Proposed Land Use: Detached Residential
 Character Area: WHCO-1
 Development Standard: Traditional
 Other Overlays: N/A
 Site Acreage: 5.89 acres
 Proposed Number of Lots: 33

- | | |
|--|-------------------------------------|
| Westhaven | SD-X Specific Development-Variety |
| AG Agricultural District | OR Office Residential District |
| ER Estate Residential | GO General Office District |
| R-1 Residential District | CC Central Commercial District |
| R-2 Residential District | NC Neighborhood Commercial District |
| R-3 Residential District | GC General Commercial District |
| R-6 Residential District | LI Light Industrial District |
| RM-10 Attached 10 Residential District | HI Heavy Industrial District |
| RM-15 Attached 15 Residential District | CI Civic and Institutional District |
| RM-20 Attached 20 Residential District | |
| SD-R Specific Development-Residential | |

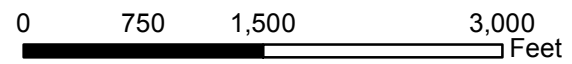

This map was created by the Franklin Planning Department. It was compiled from the most authentic information available. The City is not responsible for any errors or omissions contained herein. All data and materials (c) copyright 2016. All rights reserved.